



## Technische Informationen

### Engineering Data Sheet

# C 12.2

12" / 1.25"  
2-Way Fullrange Cabinet

### Features:

- Multi-Functional 2-Way Cabinet
- 500 W, 8 Ohms
- 90° x 50° Coverage Pattern
- 97 dB Sensitivity, 130 dB Maximum SPL
- Crossover with HF Protection
- SMX2120 LF Transducer
- DH3 Compression Driver
- Pole Mount for Tripod Use
- M8 Threaded Points
- Mounting Points to attach optional Mounting Bracket

	C 12.2
<b>Order No.</b>	F01U165091
<b>Cabinet</b>	Fullrange
<b>Configuration</b>	Passive 2-Way
<b>Nominal impedance</b>	8 Ohms
<b>Minimum Impedance</b>	5.7 Ohms
<b>Rated Power RMS</b>	500 W
<b>Peak Power</b>	2000 W
<b>Sound pressure level</b>	
<b>SPL 1 W / 1 m</b>	97 dB
<b>Max. SPL 1 m</b> (calculated with peak power)	130 dB
<b>Frequency Range (-10 dB)</b>	60 Hz to 20 kHz
<b>Nominal Coverage Angle</b> (Horizontal x Vertical)	90° x 50°
<b>X-Over Frequency</b>	1650 Hz
<b>LF Transducer</b>	SMX2120, 12" (305 mm) Driver
<b>HF Transducer</b>	DH3, 1.25" (32 mm) Diaphragm Compression Driver
<b>Connectors</b>	2x Neutrik Speakon NL4 Full-Range 1+ / 1- Wired through 2+ / 2-
<b>Dimensions (W x H x D)</b>	387 mm x 550 mm x 374 mm (15.2" x 21.7" x 14.7")
<b>Net Weight</b>	20.7 kg (45.6 lbs)
<b>Shipping Weight</b>	23.3 kg (51.4 lbs)
<b>Enclosure material</b>	MDF with D-PUR PLUS
<b>Grille</b>	Steel, Black Finish with Acoustic Gauze
<b>Suspension</b>	3x M8 Threaded Points - 1x on Each Side and 1x on the Rear of Enclosure
<b>Warranty</b>	5 years
<b>Optional Accessories</b>	
<b>DC-MBC12-UMH</b>	F01U169670
<b>TMA Tilt Angle for UMH</b>	F01U118977
<b>RMA Rotatable Mounting kit</b>	F01U118976
<b>TC-02 Truss clamp</b>	F01U100657
<b>EBK-M8 Eye Bolt Kit</b>	F01U166797
<b>Spare Parts</b>	
<b>LF Transducer</b>	F01U134308
<b>HF Transducer</b>	F01U103119



**Wir weisen ausdrücklich darauf hin, dass bei gehängten Lautsprecherboxen die einschlägigen Sicherheitsbestimmungen zu beachten sind. Es muss unbedingt qualifizierte Fachberatung in Anspruch genommen werden!**

**We expressly point out that the relevant safety regulations must be observed for "flying" loudspeaker systems. It is imperative that qualified expert advice is sought.**

#### WARNING:

**THIS LOUDSPEAKER SYSTEM CAN PERMANENTLY DAMAGE HEARING! USE EXTREME CARE WHEN SETTING SOUND PRESSURE LEVELS!**

#### DANGER:

**CONSULT A CERTIFIED STRUCTURAL ENGINEER BEFORE ANY ATTEMPT TO SUSPEND THIS LOUDSPEAKER! LOUDSPEAKER CAN FALL FROM IMPROPER SUSPENSION, RESULTING IN SEVERE INJURY AND DAMAGE OF PROPERTY. DO NOT SUSPEND OR MOUNT ANY OTHER PRODUCT OR DEVICE FROM THIS LOUDSPEAKER ENCLOSURE! USE GRADE 5 HARDWARE OR BETTER ONLY!**

## Beschreibung

Die C 12.2 ist eine kompakte, trapezförmige 12" / 2-Weg Fullrange Box mit einer sehr hohen Belastbarkeit von 500 W Continuous / 2000 W Peak und einem Wirkungsgrad von 97 dB 1W / 1m. Im Tieftonbereich kommt ein SMX 2120 Woofer zum Einsatz, im Hochtonbereich arbeitet ein DH3 Compression-Treiber in ein 90° x 50° Constant Directivity Horn für den Frequenzbereich oberhalb 1650 Hz. Flugpunkte für Eyebolts erlauben vertikale oder horizontale Aufhängung. Zusätzlich ist optional ein Montagebügel (DC-MBC12-UMH) erhältlich, der kompatibel zum DYNACORD PI-Easy Montagesystem ist und eine Ausrichtung in bis zu drei Ebenen erlaubt. Zur Erweiterung der Tieftass-Performance wird ein parallel geschalteter Sub 1.15 Subwoofer empfohlen. Diese Kombination ist auch ideal für ein Aktiv-2-Weg System zusammen mit den Controllern DSP 260 oder DSP 600 und Endstufen der SL-Serie geeignet.

## Description

The C 12.2 is a compact, trapezoidal 12" / two-way full-range cabinet offering very high power handling (500 W continuous / 2000 W peak) and sensitivity of 97 dB 1W / 1m. The low frequencies are transduced by an SMX 2120 woofer, whilst in the high frequency range, a DH3 compression driver in a 90° x 50° constant directivity horn handles everything above 1650 Hz. Flying points for eyebolts allow the cabinets to be flown vertically or horizontally. Available as an option is the DC-MBC12-UMH mounting bracket, which is compatible with the DYNACORD PI-Easy mounting system and supports up to three levels of orientation. To extend the low bass performance, a Sub 1.15 subwoofer connected in parallel is recommended. This combination is also ideal for an active two-way system together with the DSP 260 or DSP 600 controllers and power amplifiers from the SL series.

Illustration 1: Dimensions

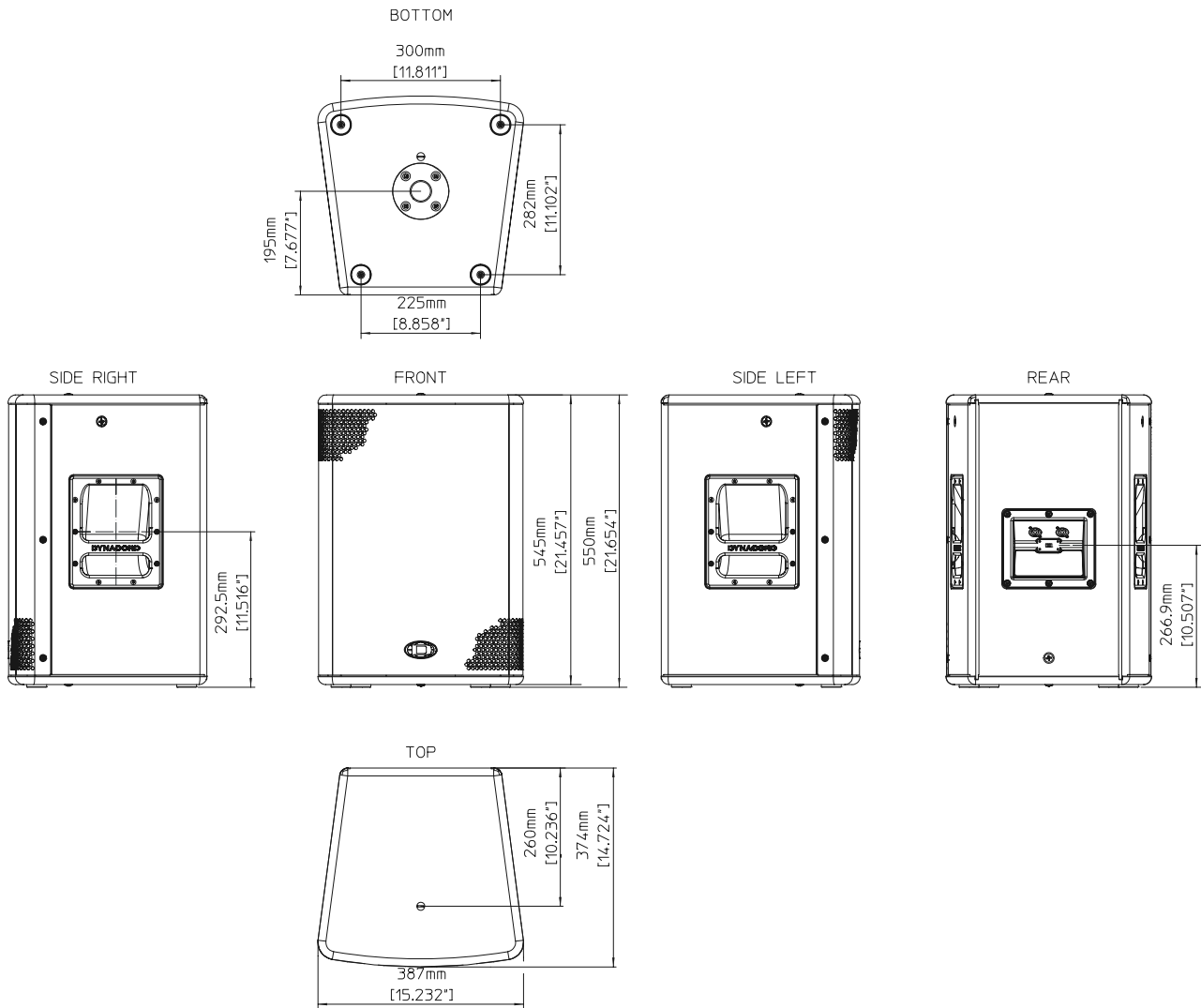

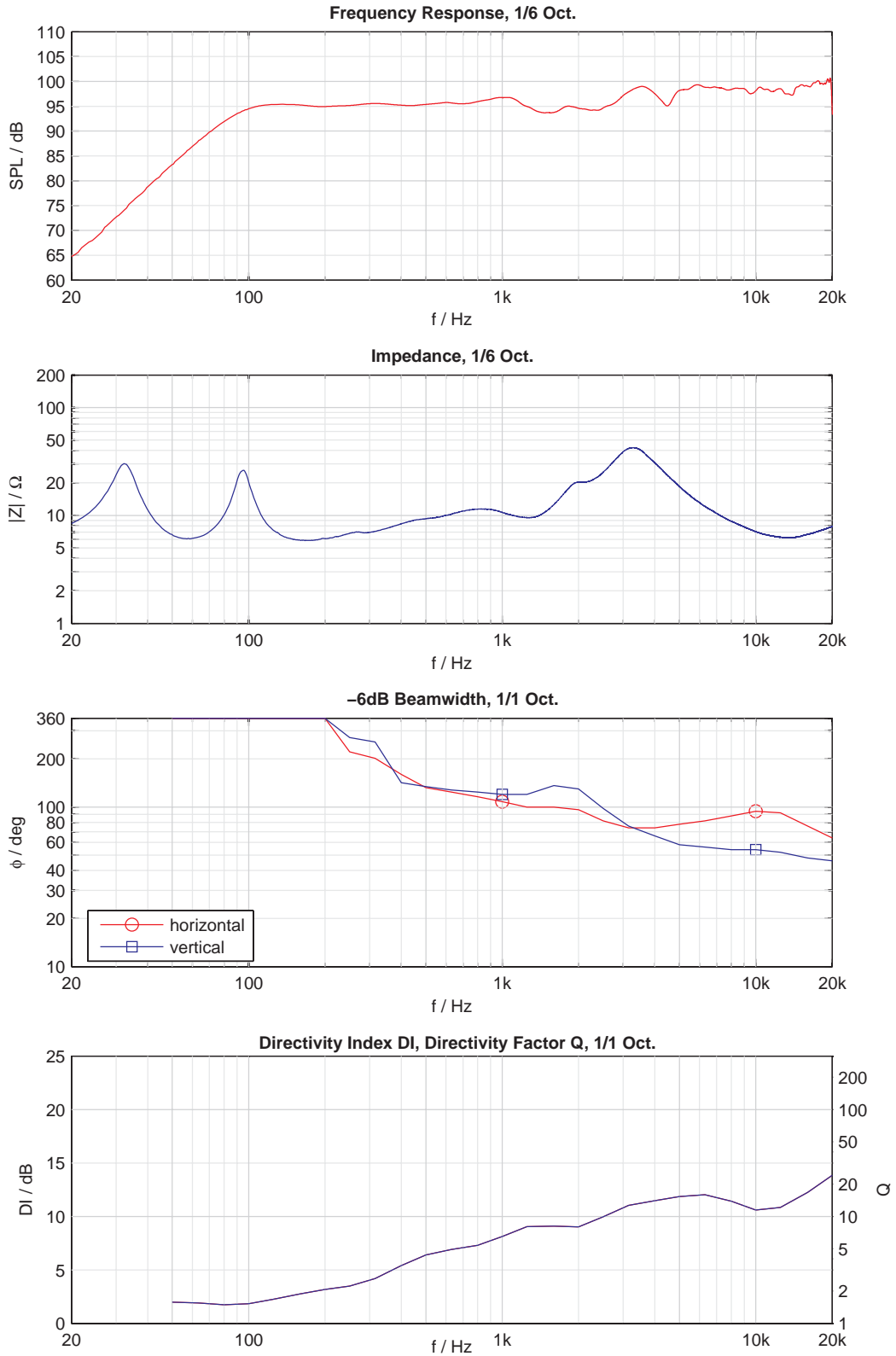

Illustration 3: Block diagram

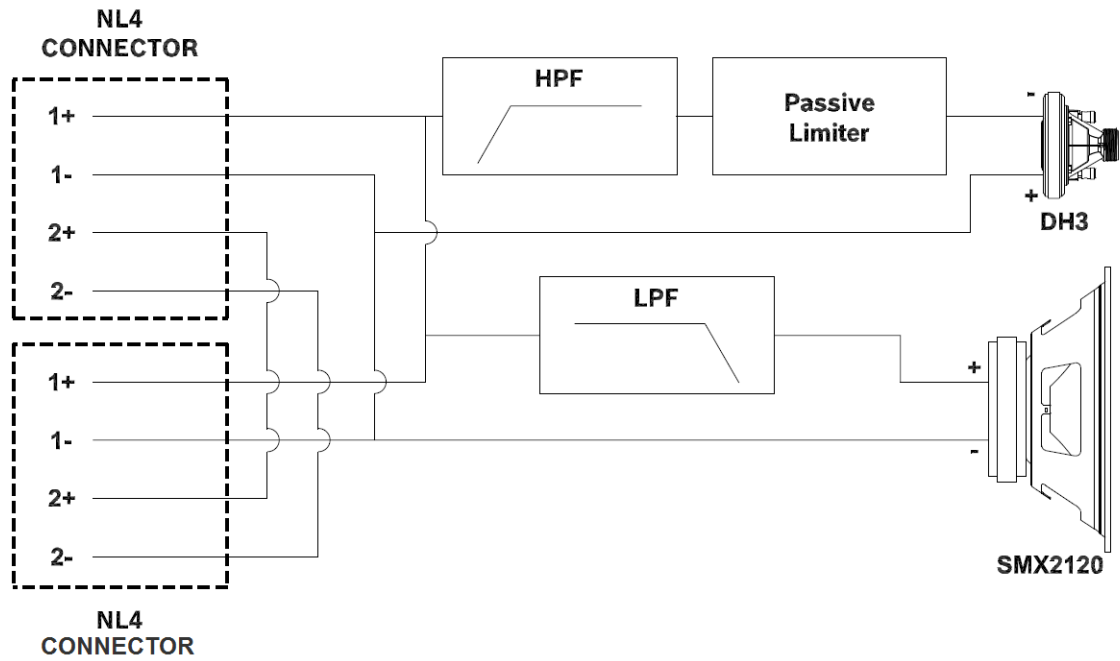
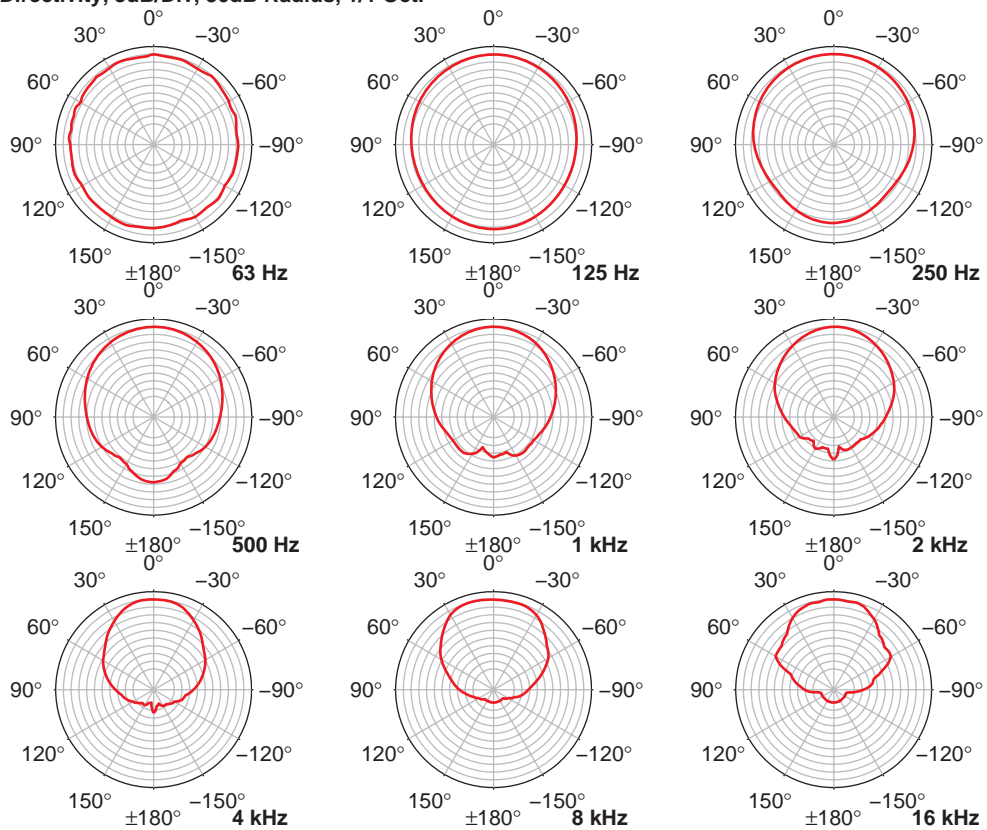
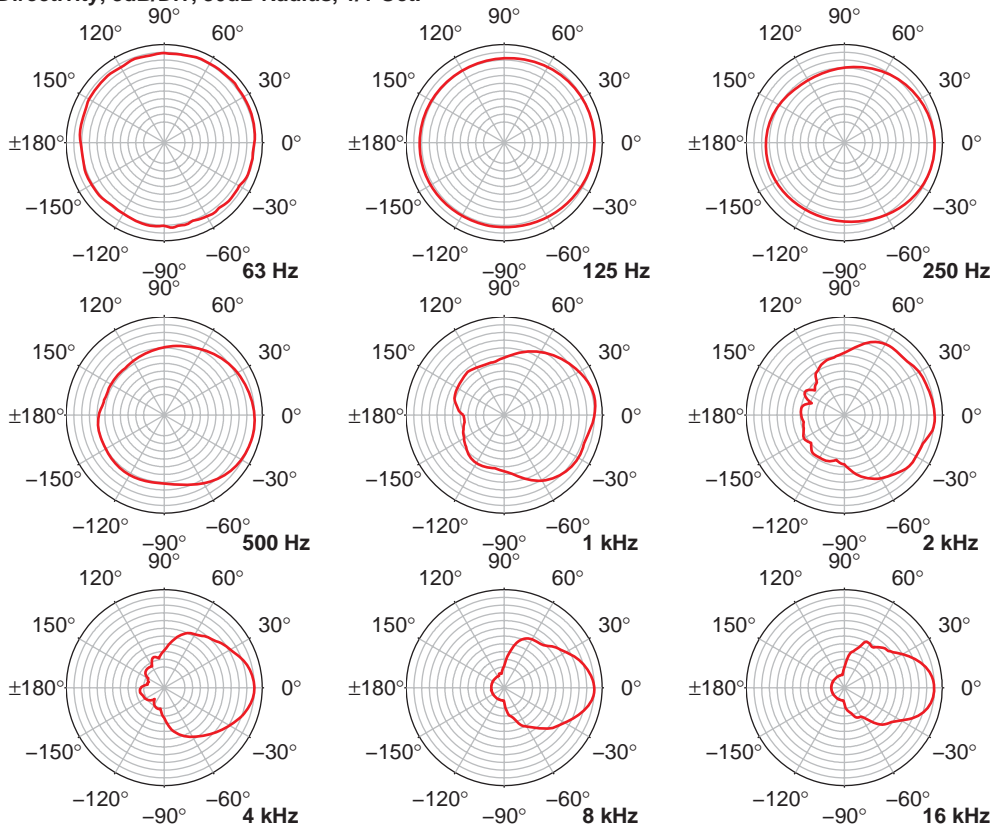

Illustration 4: Horizontal Directivity

Horizontal Directivity, 3dB/Div, 30dB Radius, 1/1 Oct.



Vertical Directivity, 3dB/Div, 30dB Radius, 1/1 Oct.



## Rigging

Illustration 6: Remove the M8 Screws from the Loudspeaker, then install the Washers and Eyebolts (EBK-M8 Eye Bolt Kit) to the Loudspeaker

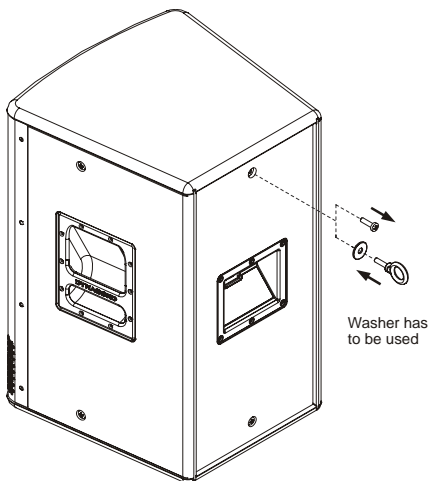

Illustration 7: Eyebolts shown oriented in the plane of pull (CORRECT)

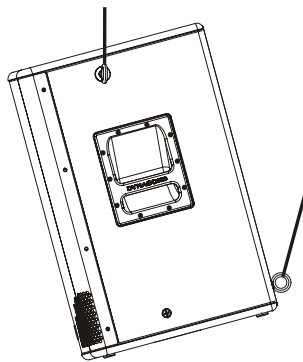

Illustration 8: Eyebolts not oriented in the plane of pull (INCORRECT)

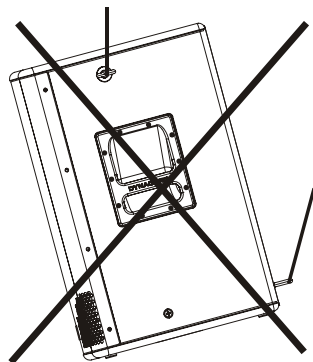

Illustration 9: Vertical orientation

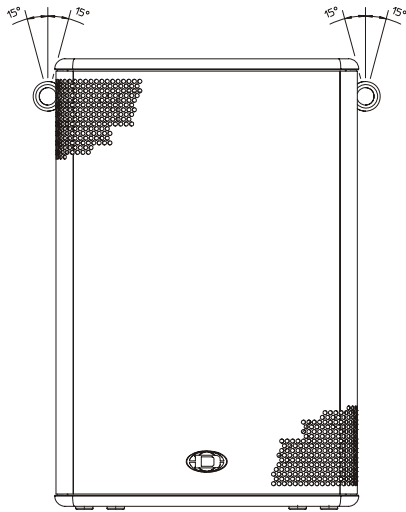
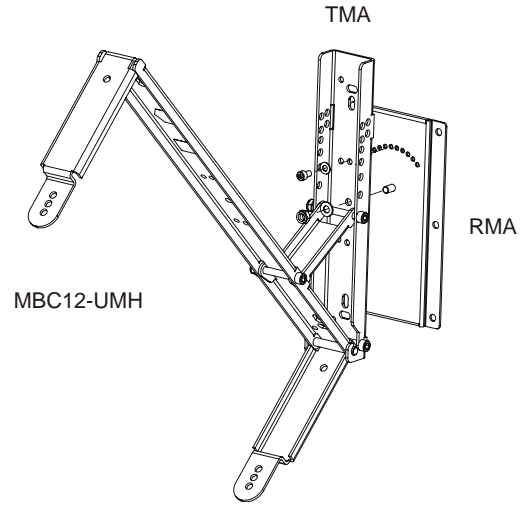

Illustration 10: Optional Accessories



**CAUTION:** Eyebolts must be fully seated and orient in the plane of pull as shown. Always use washers under the eyebolt to distribute the load on the enclosure.



12000 Portland Avenue South, Burnsville, MN 55337, USA  
Phone: +1 952/844-4051, Fax: +1 952/884-0043

[www.dynacord.com](http://www.dynacord.com)

© Bosch Communications Systems 09/2010  
**Part Number F01U163336 Vs 01**

Europe, Africa, and Middle East only. For customer orders, contact Customer Service at:  
**+49 9421-706 0 Fax: +49 9421-706 265**

Asia & Pacific only. For customer orders, contact Customer Service at:  
**+65 6571 2534 Fax: +65 6571 2699**

For technical assistance, contact Technical Support at: **+49 9421-706 0**

Specifications subject to change without notice.